

laluhmi Chowk



1. Interiority
The walls around the courtyard make it look like a huge room.



2. Coherence
Everything converges to the Queen's seating area.

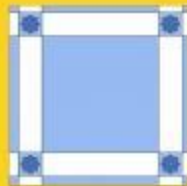

3. Order
The motifs on the floor defining the edge of the grid.



4. Discipline
The windows on the facade is the only way that women were supposed to see through.



5. Structure
Each layer has a different pattern, serving as a parapet.



6. Composition
Central composition, emphasized by multiple boundaries.



7. Circulation
The staircase behind the central gazebo, to show the multiple access to all areas.



8. Style
The motif on top of the front wall representing the grandeur.



9. Movement
Emphasizing the path followed in the space.



10. Culture
The tulsi planted in the courtyard is due to the practice of women watering and praying to it.

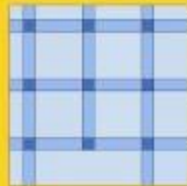

11. Multiplicity
The grid flooring in the courtyard.



12. Transformation
The narrow passages that open into the bigger courtyards.



13. Ornamentation
The detailed columns.



14. Juxtaposition
The combination of geometric and curvy patterns in the same element.



15. Connectivity
The inner verandah around the courtyard connects all the rooms.



16. Meaning
The purpose of the meeting grounds, i.e. social gatherings, festivals, etc.



17. Tolerance
The ornate and plain facade of different walls within the courtyard.



18. Adaptability
The different styles of windows on the same side.



19. Perception
Multiple layers of the palace represents different cultures moulded into a single entity.



20. Materiality
The added elements blend with all the different materials in the courtyard.



21. Scale
The different scales of the forms in the courtyard.



22. Light
Being an open courtyard, it receives ample natural light during the day.



23. Jenerality
Multiple layers bring a sense of protection to the space.



24. Historical
The Queen's seating in the balcony has the greatest meaning in terms of the story of that place.



25. Intersecting
Dividing the space in sections.



26. Layering
Various parapets and moulding to emphasize a space.



27. Virtual Form
The form is essentially a hollow cuboid.



28. Geometry
A hemisphere on the gazebo drawing attention amongst the basic squares and rectangles in the courtyard.



29. Junctions
The different forms in the space.

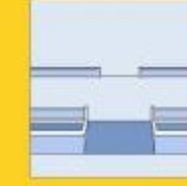

30. Access
Ramps give access to the central spaces.



31. Urban Interior
The metal dome on the gazebo seems like an urban intervention in the stone architecture.



32. Neighbourhood
The palace is on the side of lake Pichola.

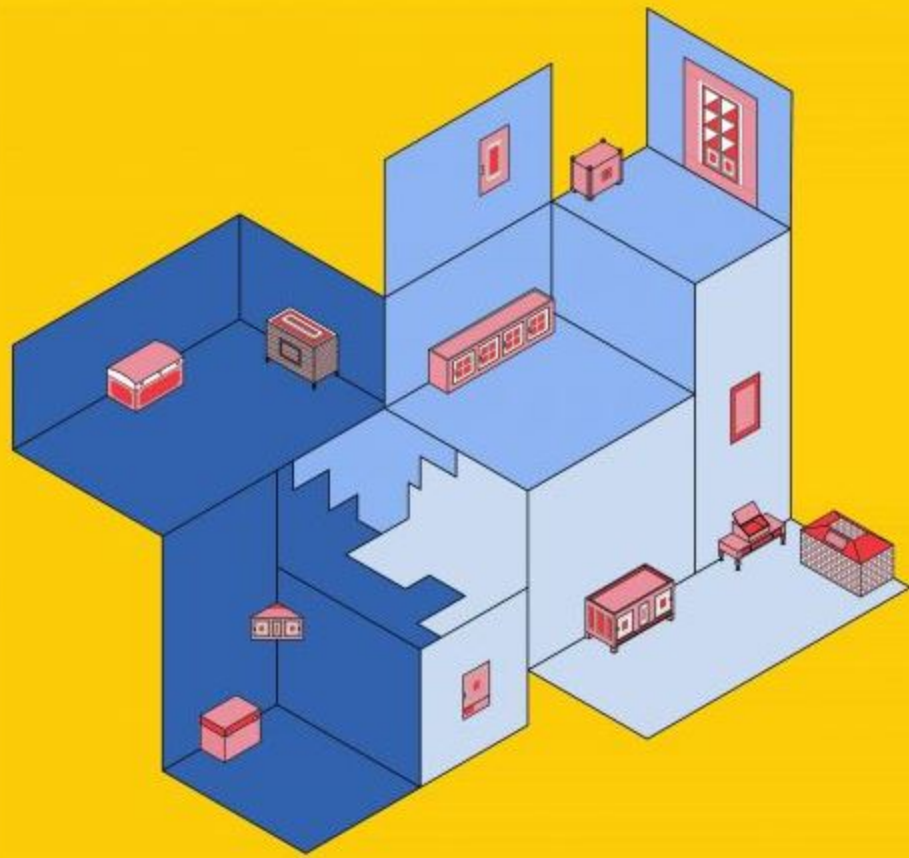

Re-discovering storage as security, privacy and secrecy

Storage and safe keeping of personal objects is a practice that has helped transform furniture, form and making. The vernacular furniture addresses this, keeping in mind the local people and their everyday needs. It builds the unique identity to a region.

This exhibition talks about the different types of storage furniture in Rajasthan. From simple storage responses like *aada* (built-in cabinet), to complex units with secret compartments like the *majju* and *bakhariya*, it celebrates the various indigenous storage solutions in the royal and frugal environments of Rajasthan. Portable pieces of storage like *peti*, *pataara* and *sandook* are also exhibited. This exhibition also displays storage elements like *bakeri*, *tiyada*, *kathatara* and *pinjara* that served multiple storage functions.

The different forms of storage units, aesthetic variations due to varied crafts involved in the making and the combination of secret compartments, add a sense of uniqueness to each piece of storage and its respective craftsman. With each question asked, the object revealed something new about its characteristic identity.

Everyday

The simple storage objects used for daily activities. Storing everyday items.

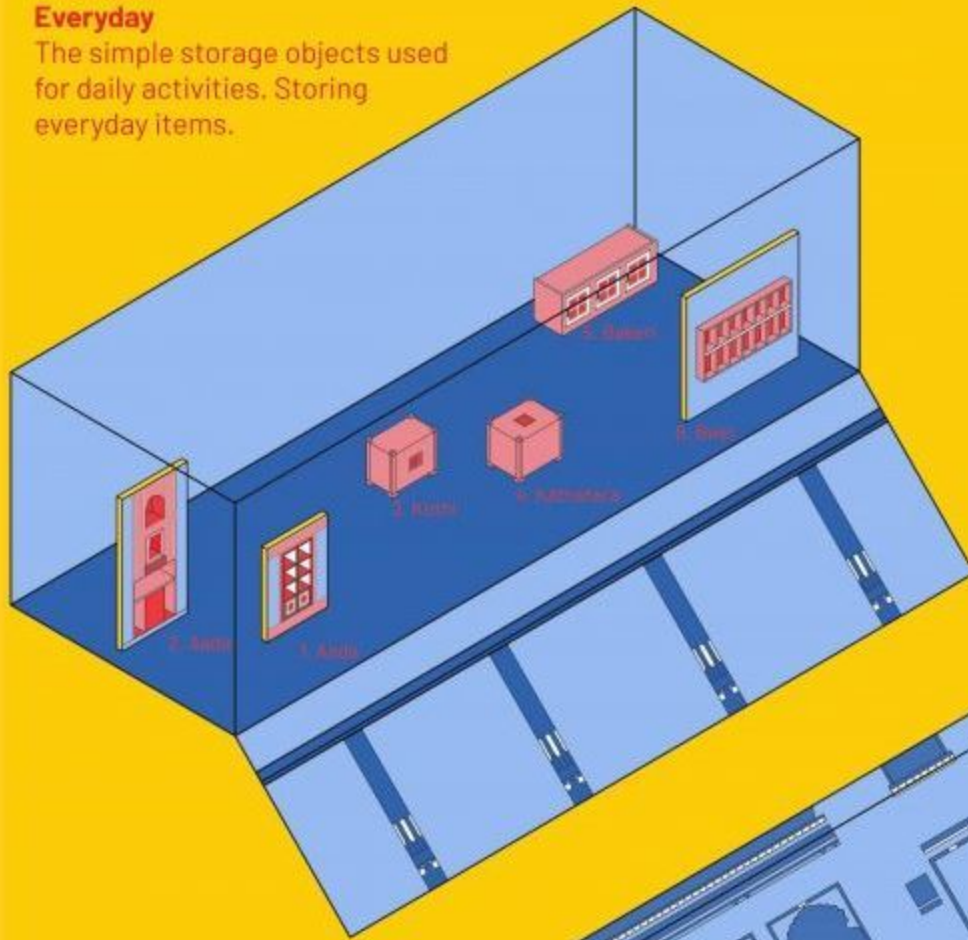

Multi-functional

These objects serve multiple types of storage needs. Everyday objects stored along with personal items.

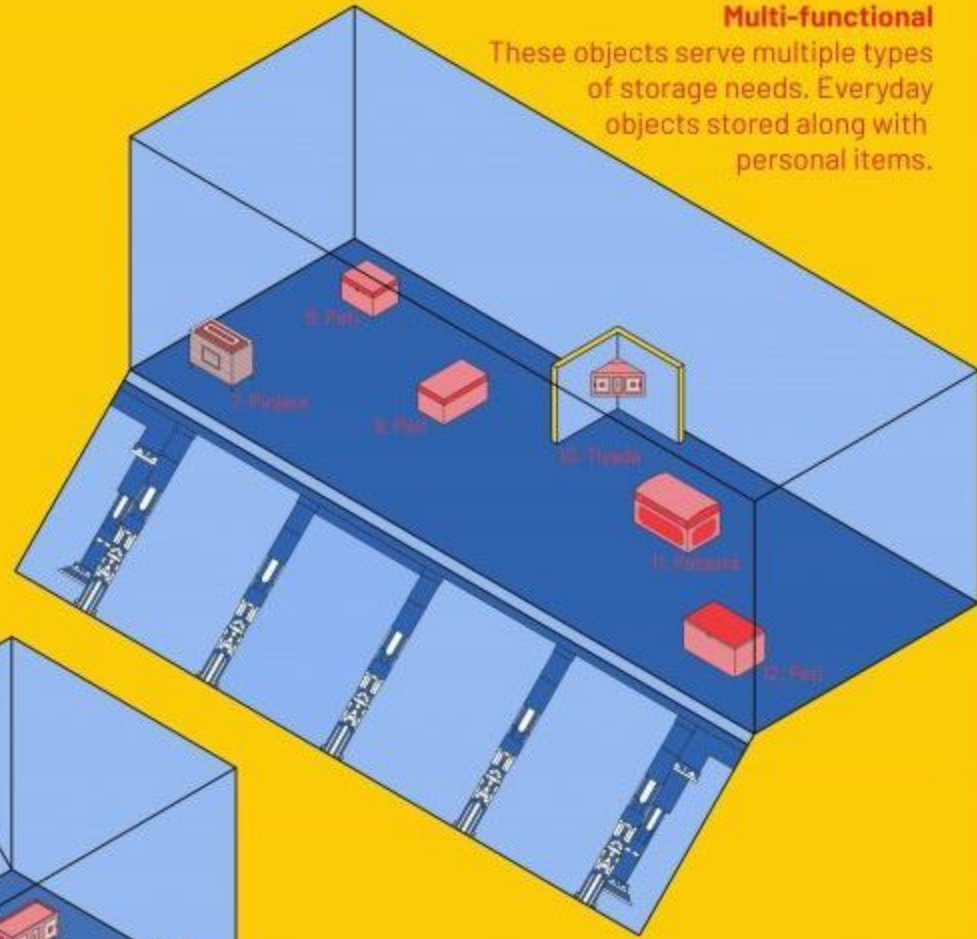

Secretive

Complex objects made with secret compartments meant to store valuable items.

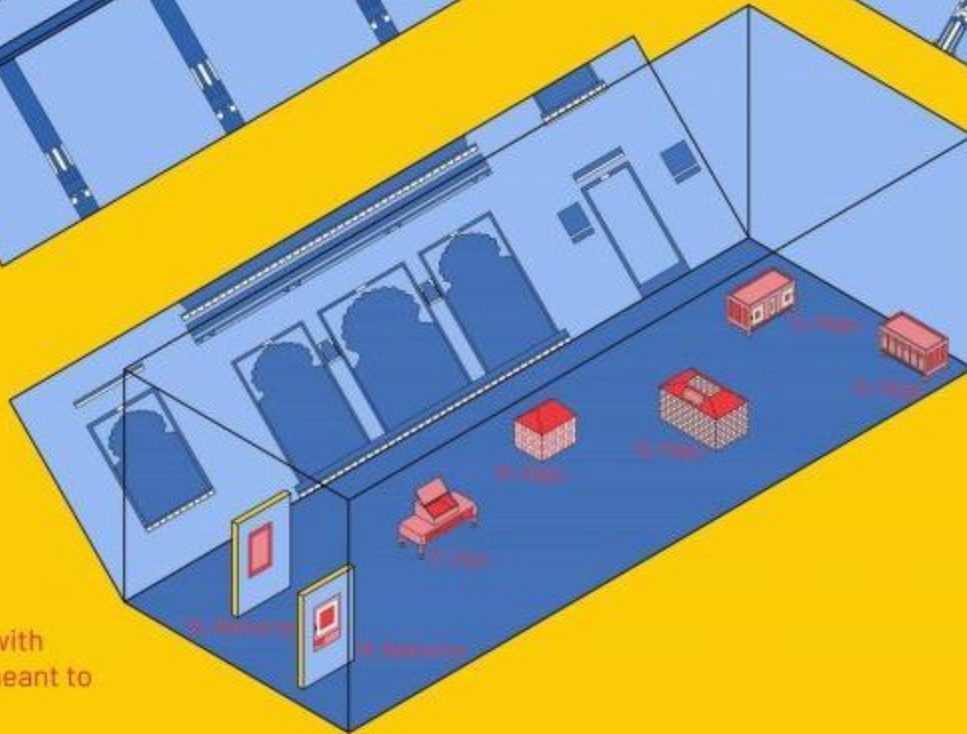

Curatorial Sequence

Re-discovering storage lakshmi Chowk

Dungarpur object Research

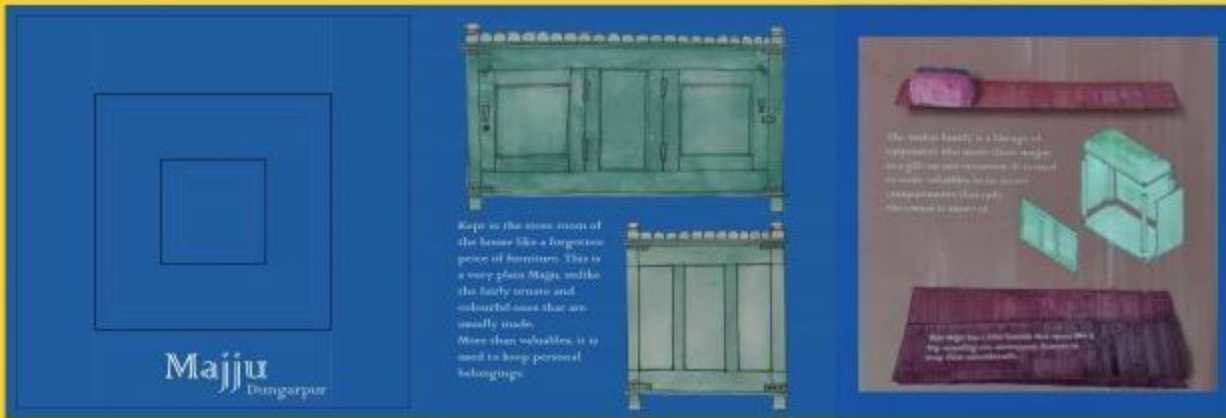

City Palace, Udaipur Museum object research



Traditional interior architecture elements

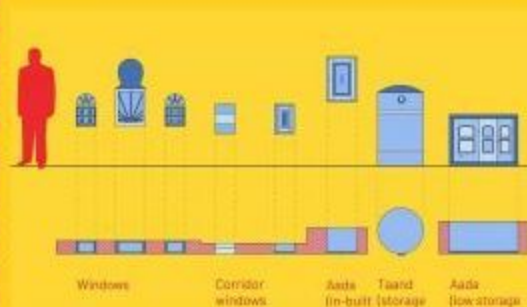

Visual spatial narrative



Re - discovering Storage

As security, privacy and secrecy

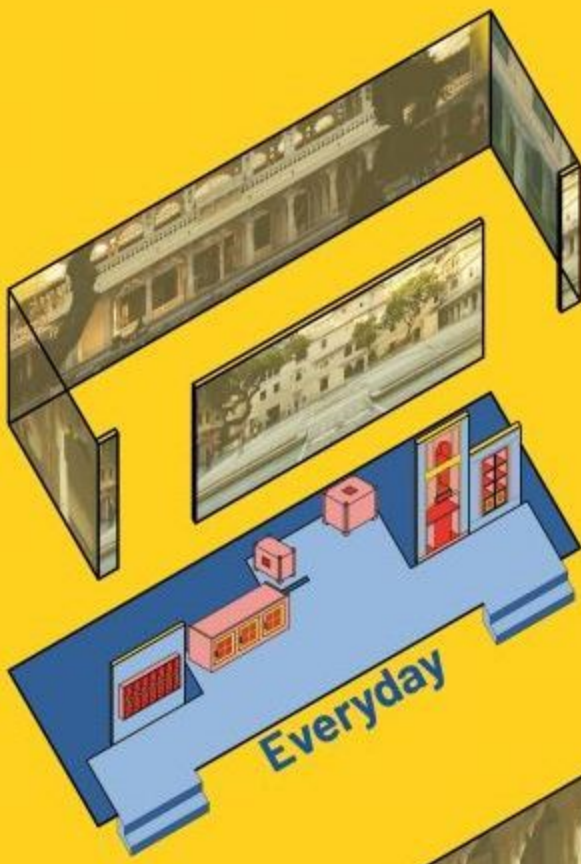
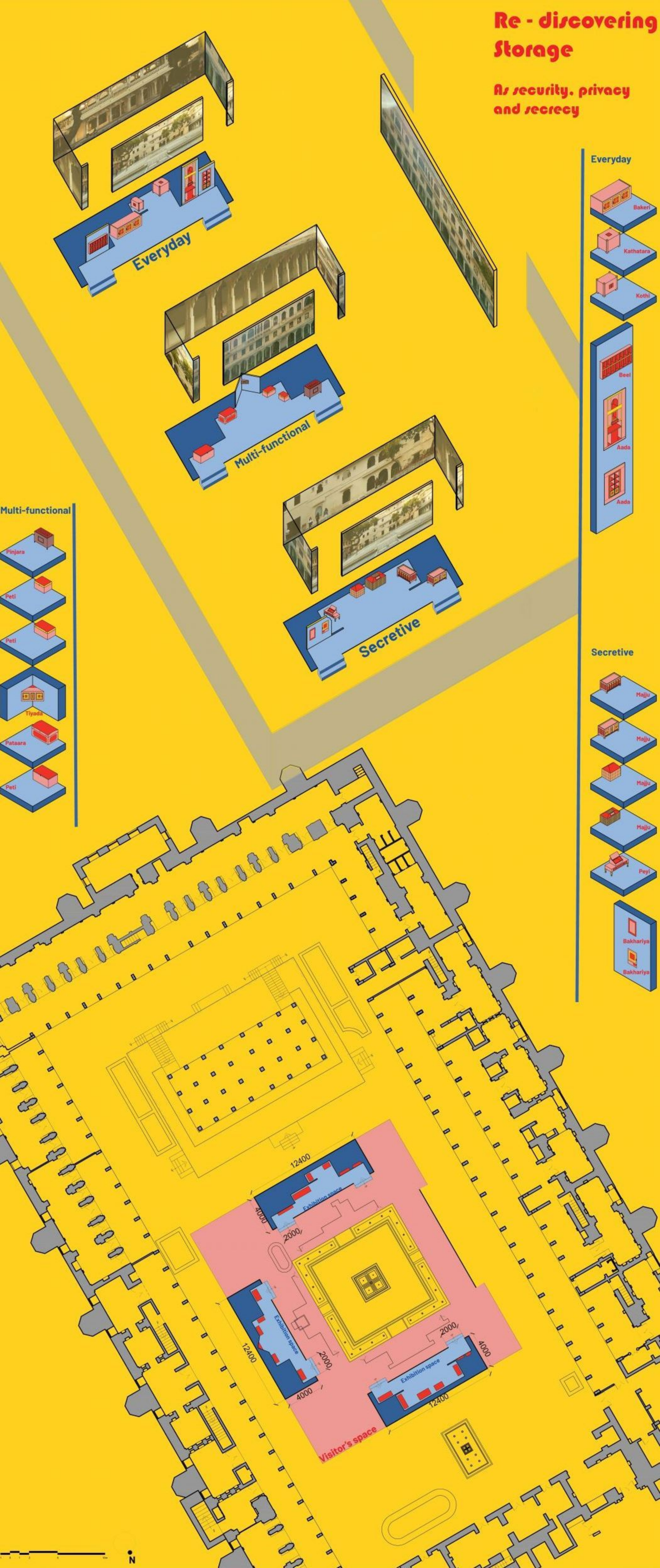

Everyday

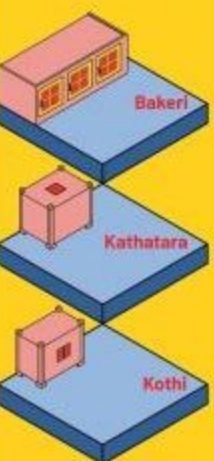

Multi-functional



Secretive

